

HAJI TOOLS & HARDWARE

HOUSE OF STAINLESS STEEL FASTENERS

Technical Specification of Wing Nuts as per DIN 315 / IS : 2636-1972

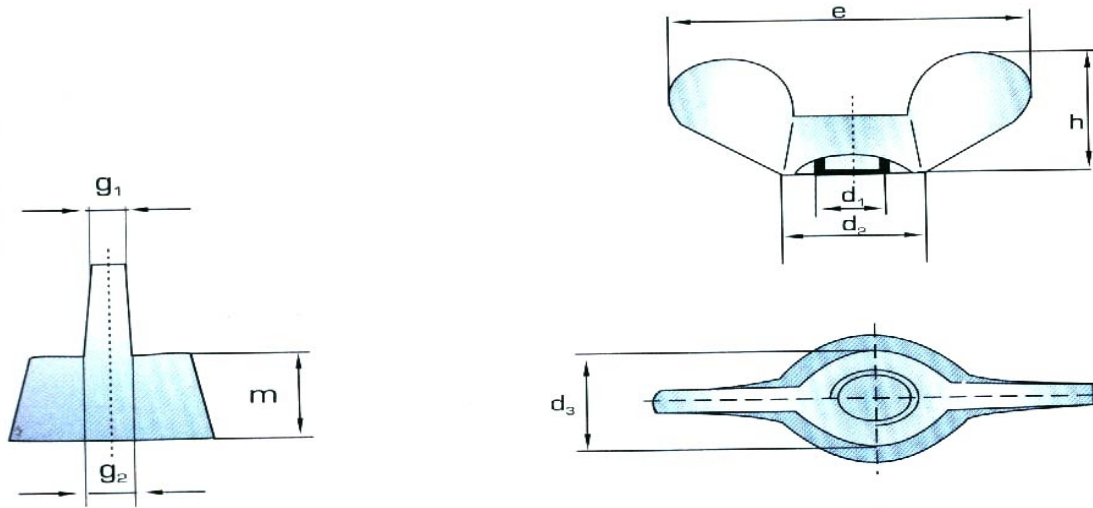

Screw Thread d_1	M4	M5	M6	M8	M10	M12	M16
Pitch	0.7	0.8	1.0	1.25	1.5	1.75	2.0
d_2 max.	8.0	11.0	13.0	16.0	20.0	23.0	29.0
min.	6.0	8.0	10.0	13.0	17.0	20.0	26.0
d_3 max.	7.0	9.0	11.0	12.5	16.5	19.5	23.0
min.	5.5	7.5	9.0	10.5	14.5	17.5	21.0
e max	20.0	26.0	33.0	39.0	51.0	65.0	73.0
min.	18.0	24.0	30.0	36.0	48.0	62.0	70.0
g_1 max.	1.9	2.3	2.3	2.8	4.4	4.9	6.4
min	1.1	1.5	1.5	2.0	3.6	4.1	5.6
g_2 max.	2.3	2.8	3.3	4.4	5.4	6.4	7.5
min	1.7	2.3	2.7	3.6	4.6	5.6	6.5
H max.	10.5	13.0	17.0	20.0	25.0	33.5	37.5
min.	8.5	11.0	15.0	18.0	23.0	31.0	35.0
m max.	4.6	6.5	8.0	10.0	12.0	14.0	17.0
min.	3.2	4.0	5.0	6.5	8.0	10.0	13.0

HAJI TOOLS & HARDWARE

HOUSE OF STAINLESS STEEL FASTENERS

Technical Specification of Square Nuts as per DIN 557

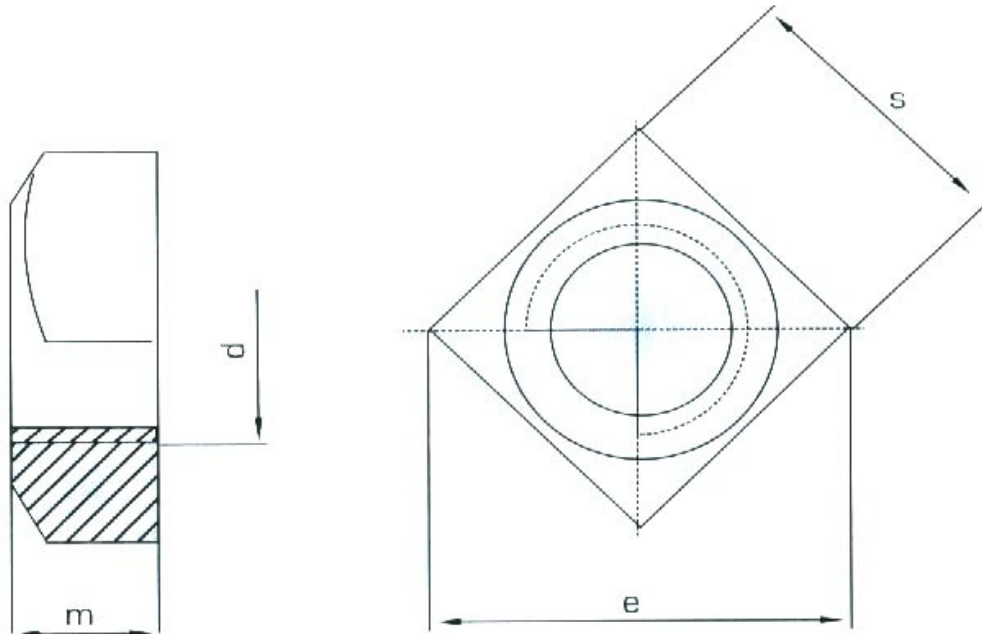

Thread Size	M5	M6	M8
Pitch	0.8	1	1.25
e	11.3	14.1	18.4
max.	4.6	5.6	7.25
m. max.	4.6	5.6	7.25
min.	3.4	4.4	5.75
s min	8	10	13
	7.64	9.64	12.57

HAJI TOOLS & HARDWARE

HOUSE OF STAINLESS STEEL FASTENERS

Technical Specification of Hexagon Domed Cap Nuts as per DIN 1587 / IS : 7790-1975

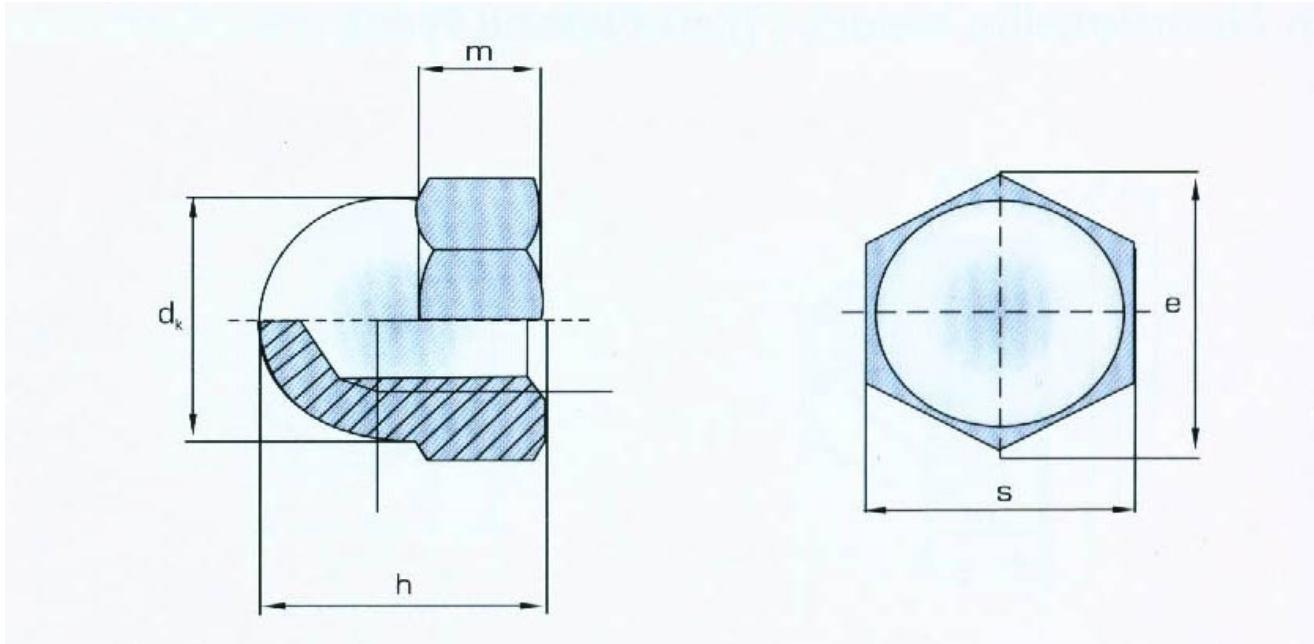

Thread Size [d]	M4	M5	M6	M8	M10	M12	M16
Pitch	0.7	0.8	1.0	1.25	1.5	1.75	2.0
h max.	8.0	10.0	12.0	15.0	18.0	22.0	28.0
m max.	3.2	4.0	5.0	6.5	8.0	10.0	13.0
min	2.9	3.7	4.7	6.14	7.64	9.64	12.3
s max.	7.0	8.0	10.0	13.0	17	19	24.0
dk max.	6.5	7.5	9.5	12.5	16	18	23.0