

MATERIAL LIST

FLAT BAR, .375 THK, HR, CF STEEL, 1018
 -OR-
 INVESTMENT CAST

ASTM A108
 300 SERIES STAINLESS STEEL

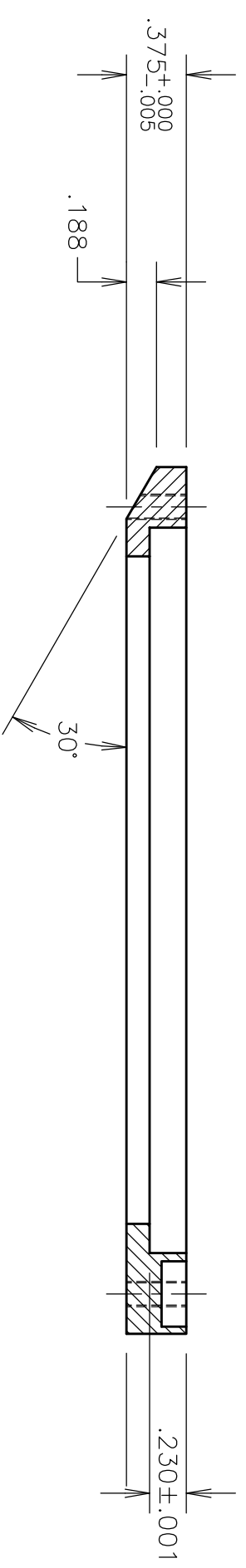
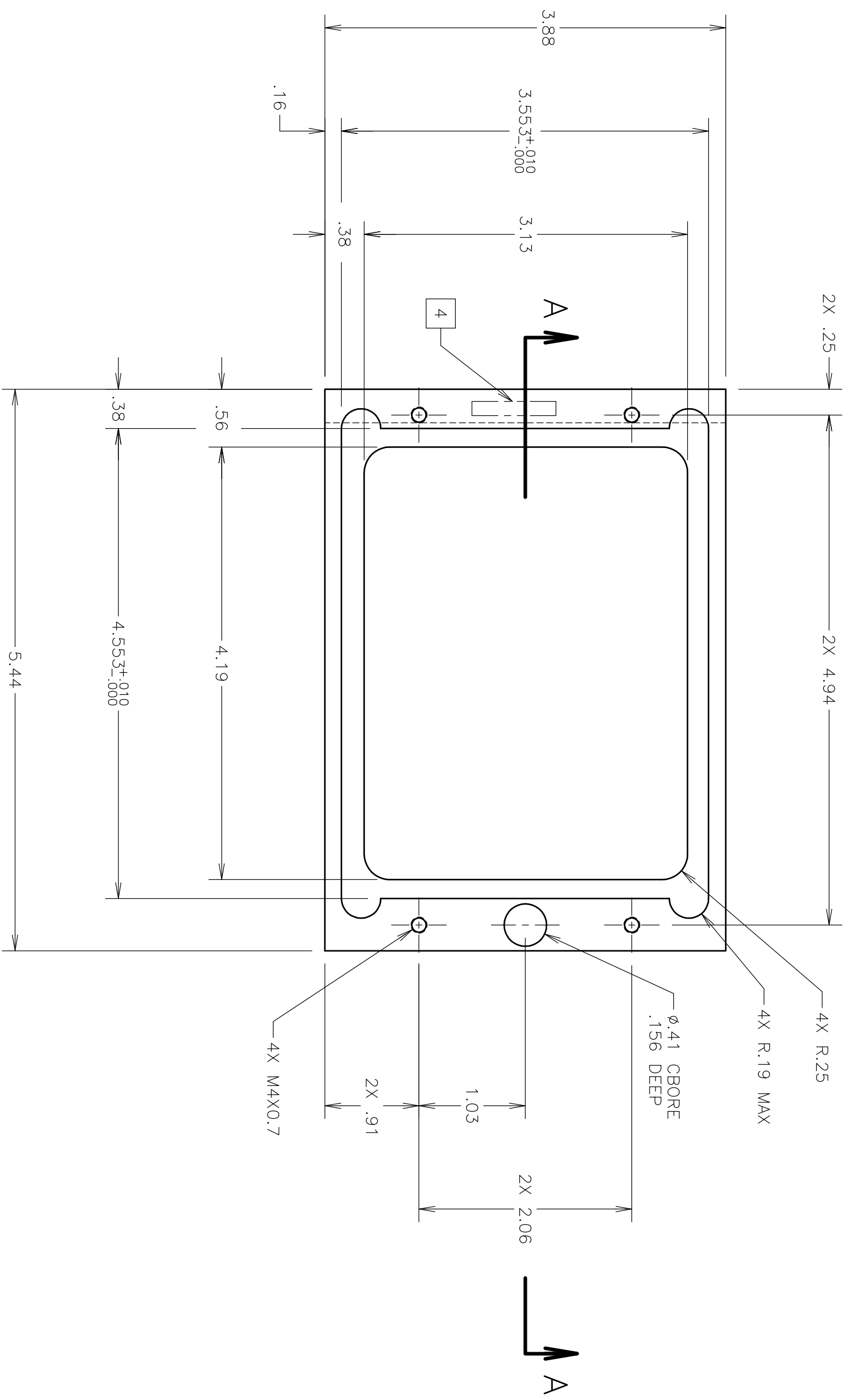

SECTION A-A

- NOTES: UNLESS OTHERWISE SPECIFIED
1. DIMENSIONING AND TOLERANCING PER ASME Y14.5M-1994.
 2. BREAK ALL SHARP EDGES.
 3. CLEAN AND DEBURR ALL THREADS.
 4. IMPRESSION STAMP 07217R2, .25 HIGH, IN APPROX LOCATION SHOWN.
 5. SURFACE FINISH SHALL BE 125
 6. MAX FILLET RADIUS: .01.

<small>DRIVING OR ELECTRONIC FILES REPRESENTING THIS DRAWING ARE NOT GUARANTEED TO BE ACQUIRABLE. ANY USE OF THE SAME FOR PROGRAMMING PURPOSES IS AT THE USER'S RISK. ALL PARTS MUST CONFORM TO DIMENSIONS AND TOLERANCES CALLED OUT ON THE APPROVED HARD COPY DRAWING.</small>		<small>UNLESS OTHERWISE SPECIFIED, ALL DIMENSIONS ARE IN INCHES AND DECIMALS THEREOF.</small>									
NO.	BY	APPR.	DATE	REVISIONS	SOURCE	PROD. GENERAL FOR APC	SCALE FULL	CHKD. CW	DRWING	IH	DATE
1	BLG		3/3	SEE EGN NO. 1100	X-X-X	SCALE FULL					
2	DJW		01/19	AND GEN DWG UPDATE		TOLERANCE UNLESS NOTED:					
				SEE EGN NO. 2418		ANGLE ±1°	X ± .1				
						.XX ± .01	.XXX ± .005	DATE	08/01/94		

INTERNATIONAL

ANTHONY-ROSS COMPANY
 BEAVERTON, OREGON 97008

LATCHING WINDOW
 DRAWING NUMBER
 07217

REV. 2

